

Notes:
 White/Black reversed parts code (written by white text on black circle)
 This parts are different by model and defined multiple parts code (please check SPI for actual parts code)
 By case , some model have no parts though the parts is shown on this diagram.

Addition of Ref B1890, Change of Ref B2290.		C
Change of Ref B0965.		B
First Release		A
History		Rev.No
Model Name	EB-L12000Q/L12002Q/EB-L2000U/L2000U	

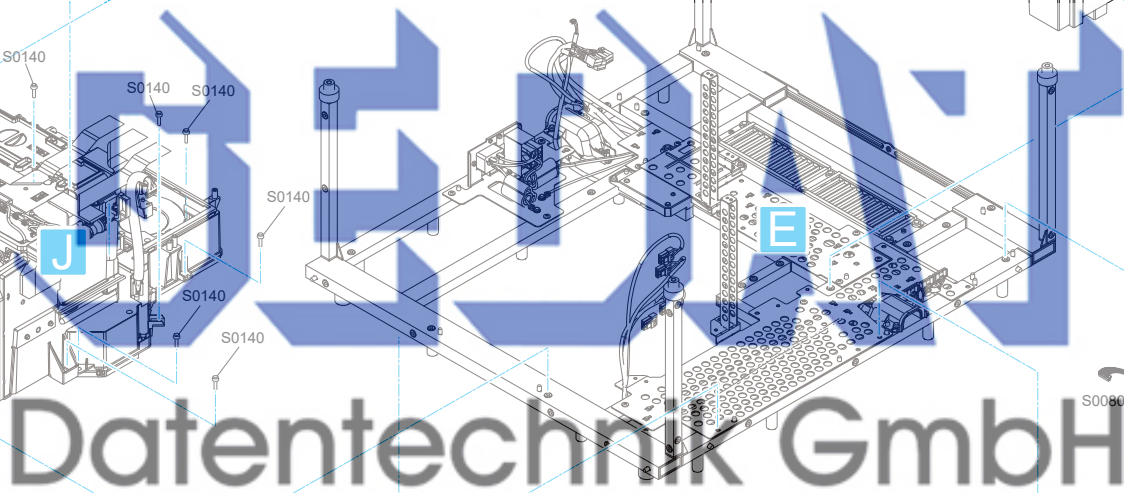
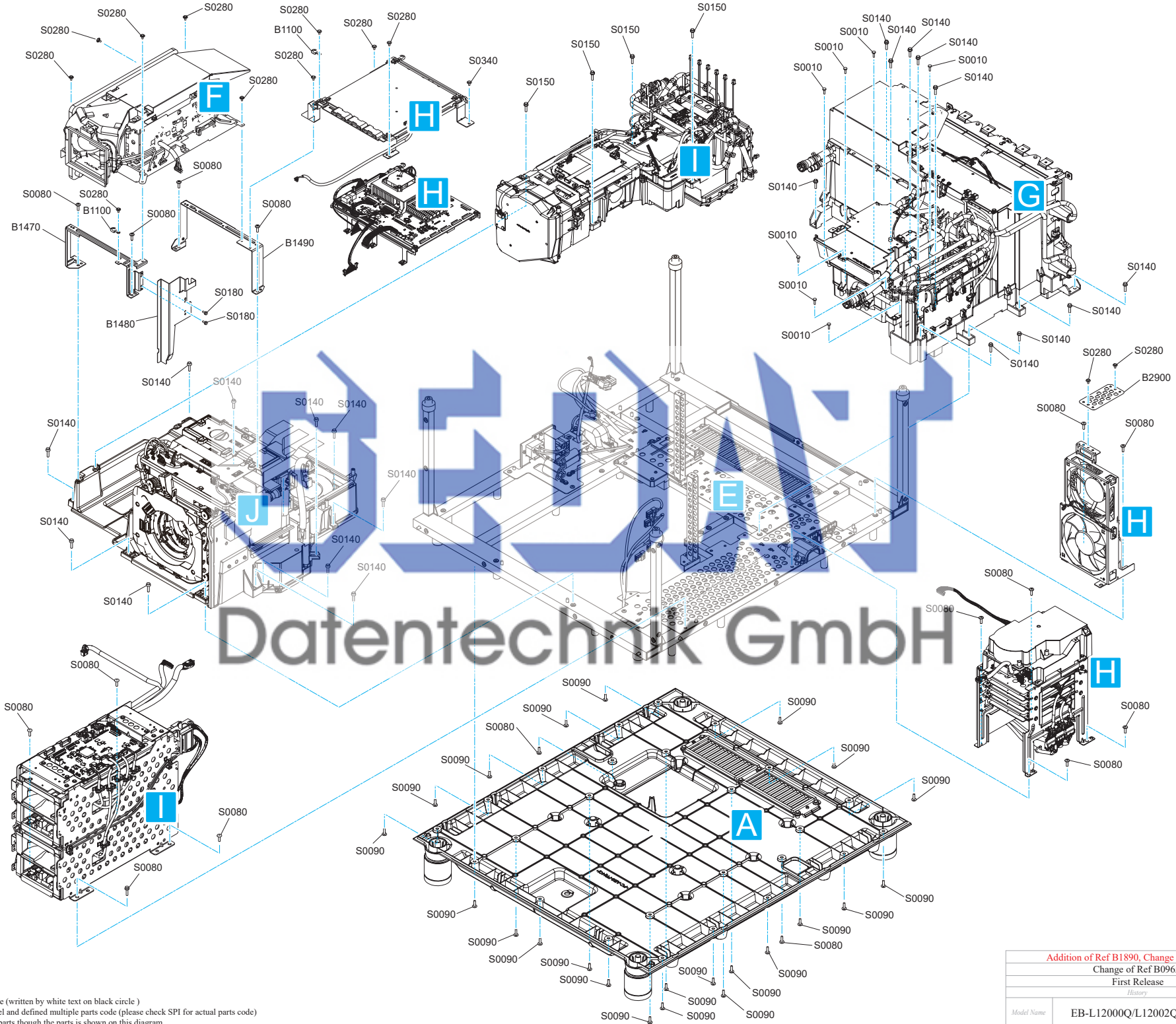

Datentechnik GmbH

Notes:
 White/Black reversed parts code (written by white text on black circle)
 This parts are different by model and defined multiple parts code (please check SPI for actual parts code)
 By case ,some model have no parts though the parts is shown on this diagram.

Addition of Ref B1890, Change of Ref B2290.		C
Change of Ref B0965.		B
First Release		A
History		Rev. No.
Model Name	EB-L12000Q/L12002Q/EB-L20000U/L20002U	

A

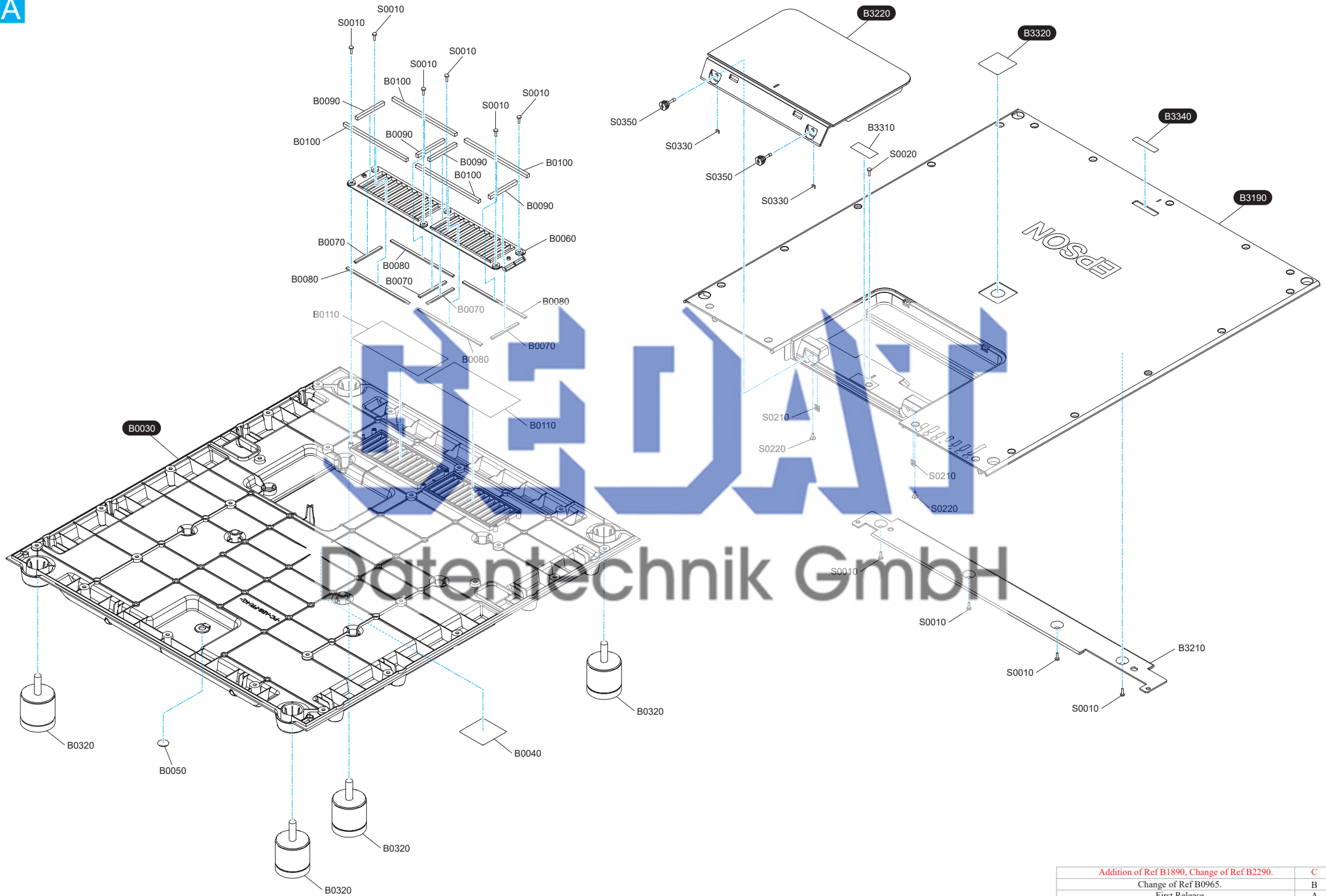

Notes:
 White/Black reversed parts code (written by white text on black circle)
 This parts are different by model and defined multiple parts code (please check SPI for actual parts code)
 By case , some model have no parts though the parts is shown on this diagram.

Addition of Ref B1890, Change of Ref B2290.		C
Change of Ref B0965.		B
First Release		A
History		Rev.No.
Model Name	EB-L20000U/L20002U	

A

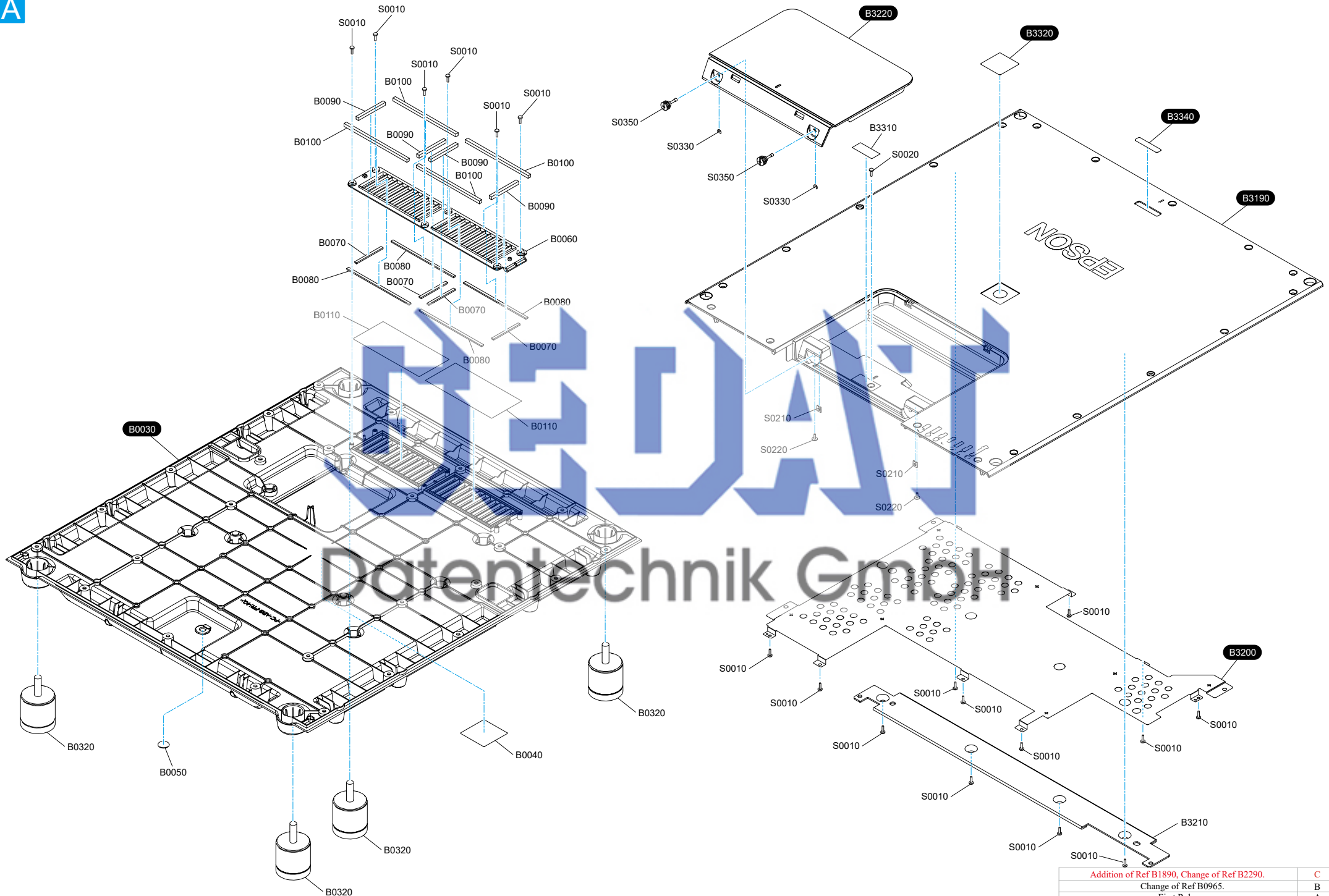

Notes:
 White/Black reversed parts code (written by white text on black circle)
 This parts are different by model and defined multiple parts code (please check SPI for actual parts code)
 By case , some model have no parts though the parts is shown on this diagram.

Addition of Ref B1890, Change of Ref B2290.		C
Change of Ref B0965.		B
First Release		A
History		Rev.No
Model Name	EB-L12000Q/L12002Q	

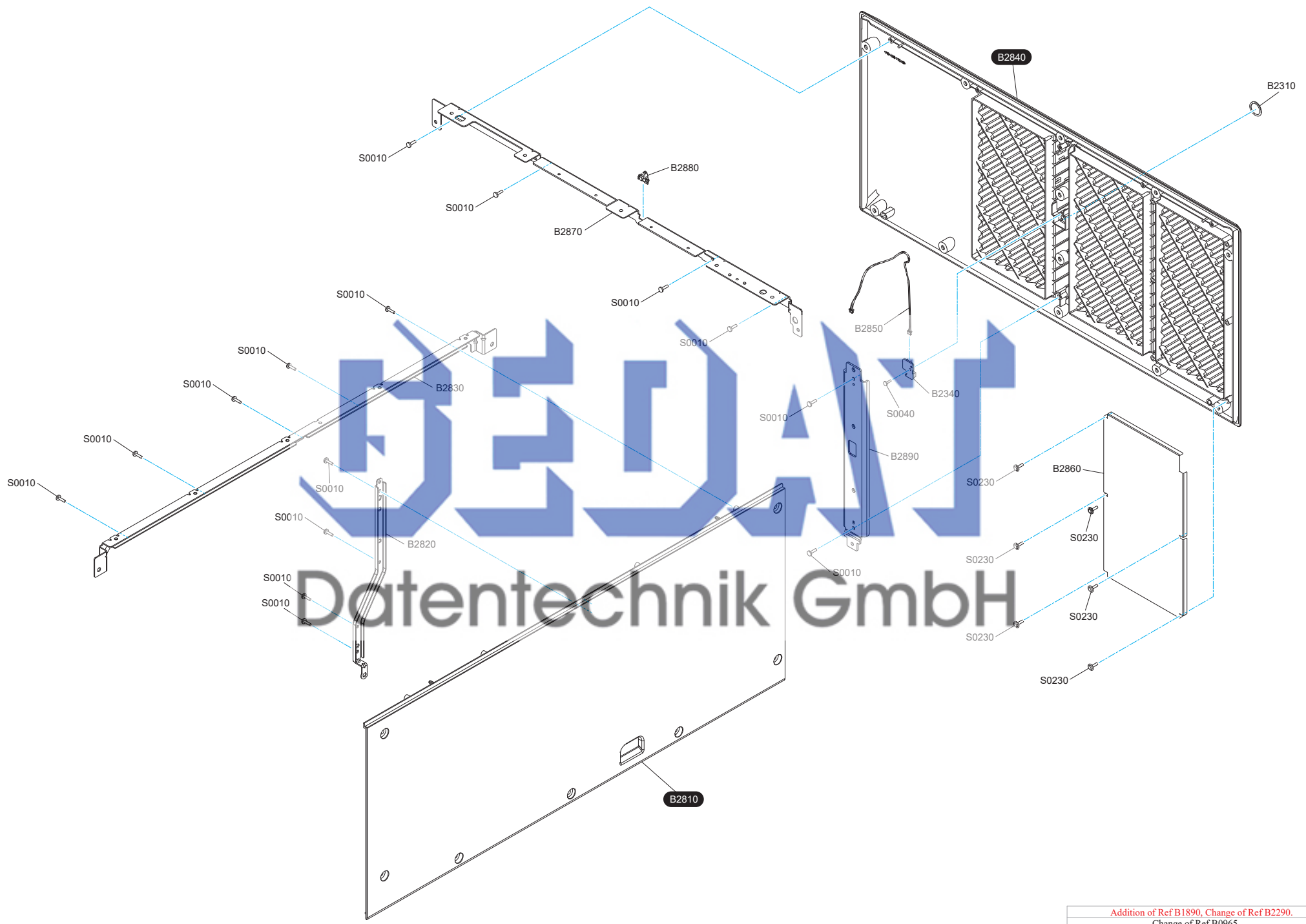

Datentechnik GmbH

Notes:
 White/Black reversed parts code (written by white text on black circle)
 This parts are different by model and defined multiple parts code (please check SPI for actual parts code)
 By case , some model have no parts though the parts is shown on this diagram.

Addition of Ref B1890, Change of Ref B2290.		C
Change of Ref B0965.		B
First Release		A
<i>History</i>		<i>Rev.No.</i>
Model Name	EB-L12000Q/L12002Q/EB-L20000U/L20002U	

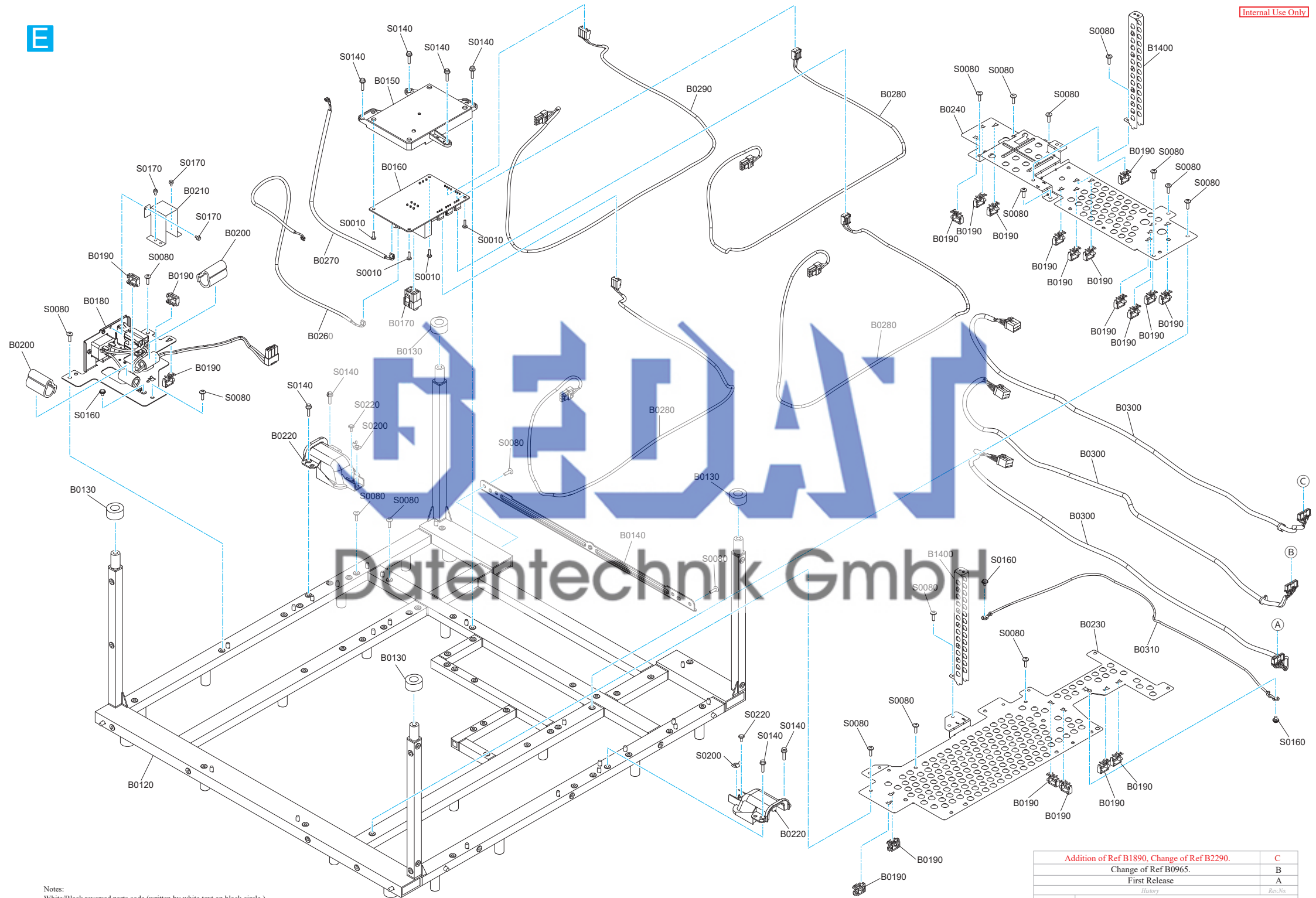

Notes:
 White/Black reversed parts code (written by white text on black circle)
 This parts are different by model and defined multiple parts code (please check SPI for actual parts code)
 By case , some model have no parts though the parts is shown on this diagram.

Addition of Ref B1890, Change of Ref B2290.		C
Change of Ref B0965.		B
First Release		A
<i>History</i>		<i>Rev.No</i>
Model Name	EB-L12000Q/L12002Q/EB-L20000U/L20002U	

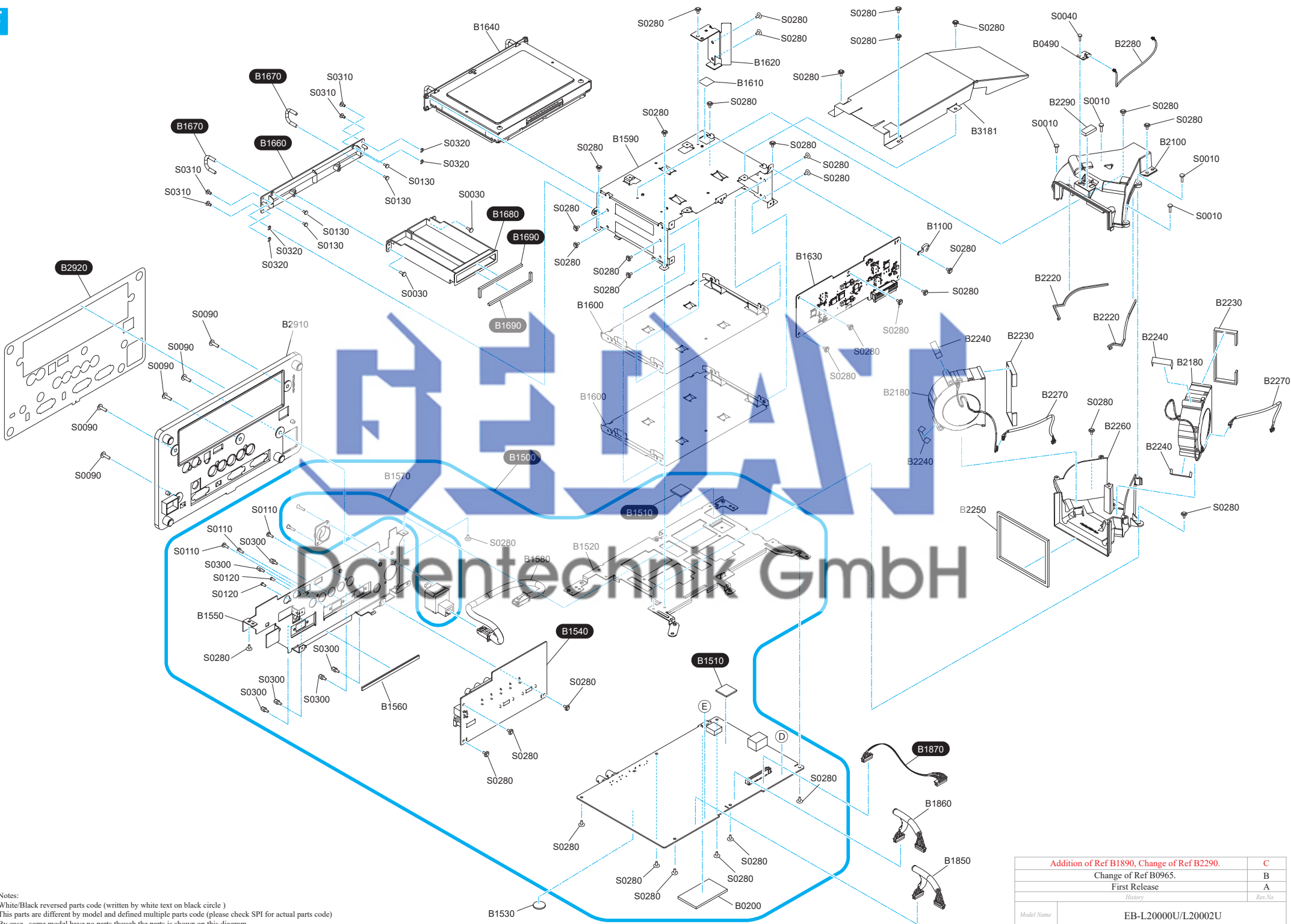

Datentechnik GmbH

Notes:
 White/Black reversed parts code (written by white text on black circle)
 This parts are different by model and defined multiple parts code (please check SPI for actual parts code)
 By case , some model have no parts though the parts is shown on this diagram.

Addition of Ref B1890, Change of Ref B2290.		C
Change of Ref B0965.		B
First Release		A
<i>History</i>		<i>Rev.No</i>
<i>Model Name</i>	EB-L20000U/L20002U	

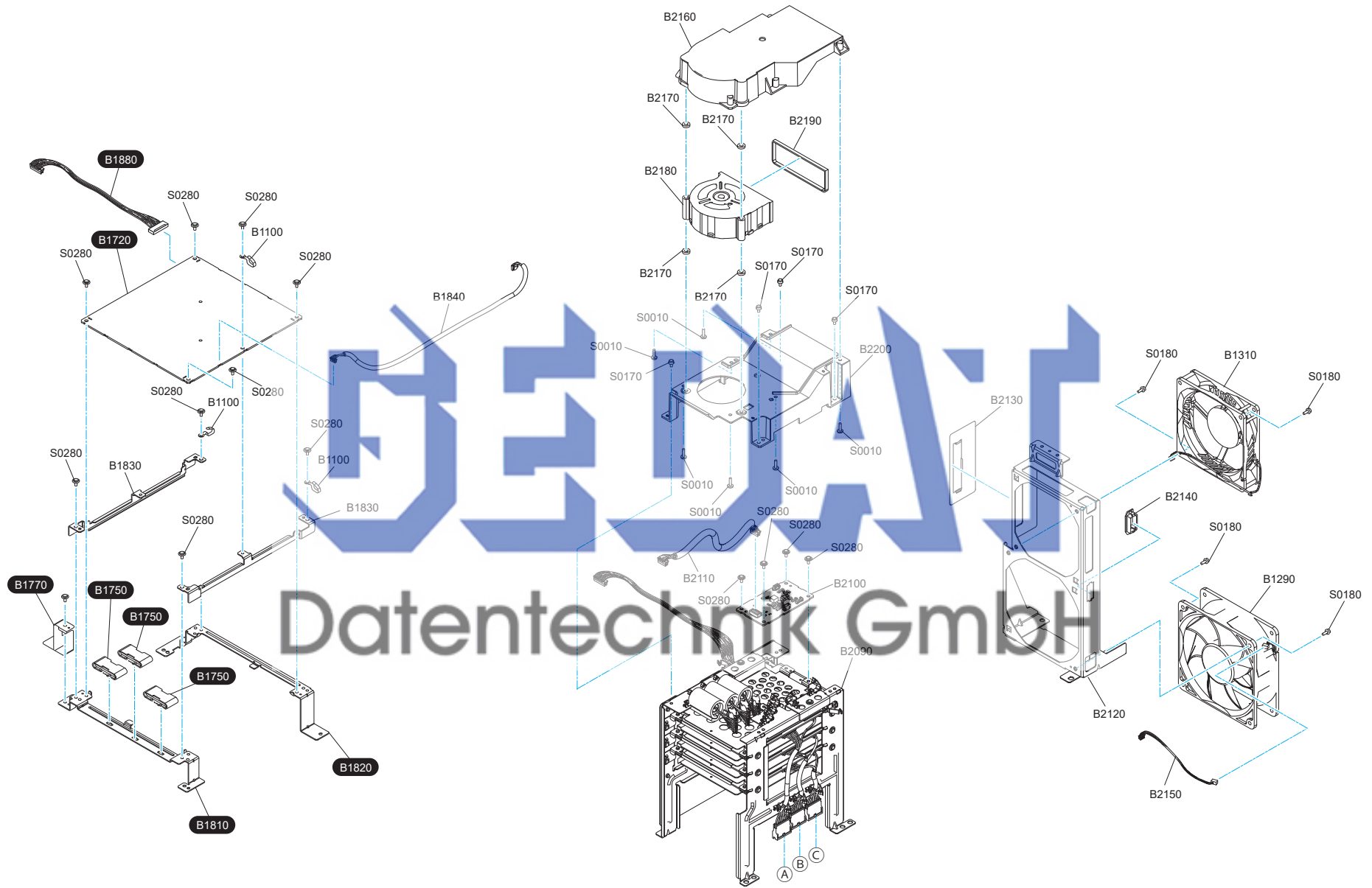

Notes:
 White/Black reversed parts code (written by white text on black circle)
 This parts are different by model and defined multiple parts code (please check SPI for actual parts code)
 By case , some model have no parts though the parts is shown on this diagram.

Addition of Ref B1890, Change of Ref B2290.		C
Change of Ref B0965.		B
First Release		A
History		Rev.No.
Model Name	EB-L20000U/L20002U	

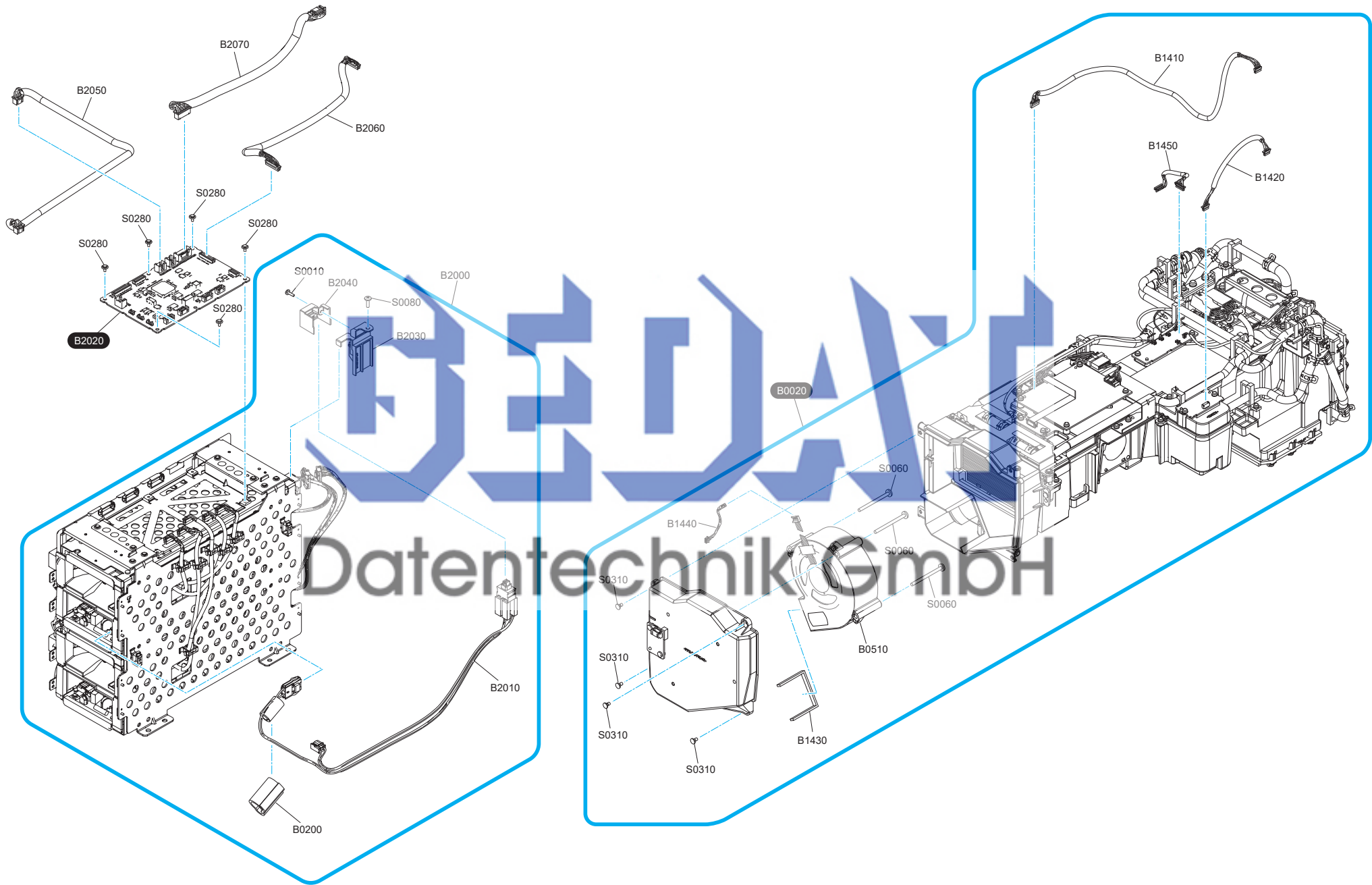

Notes:
 White/Black reversed parts code (written by white text on black circle)
 This parts are different by model and defined multiple parts code (please check SPI for actual parts code)
 By case , some model have no parts though the parts is shown on this diagram.

	Addition of Ref B1890, Change of Ref B2290.	C
	Change of Ref B0965.	B
	First Release	A
	History	Rev.No.
Model Name	EB-L12000Q/L12002Q/EB-L20000U/L20002U	

J

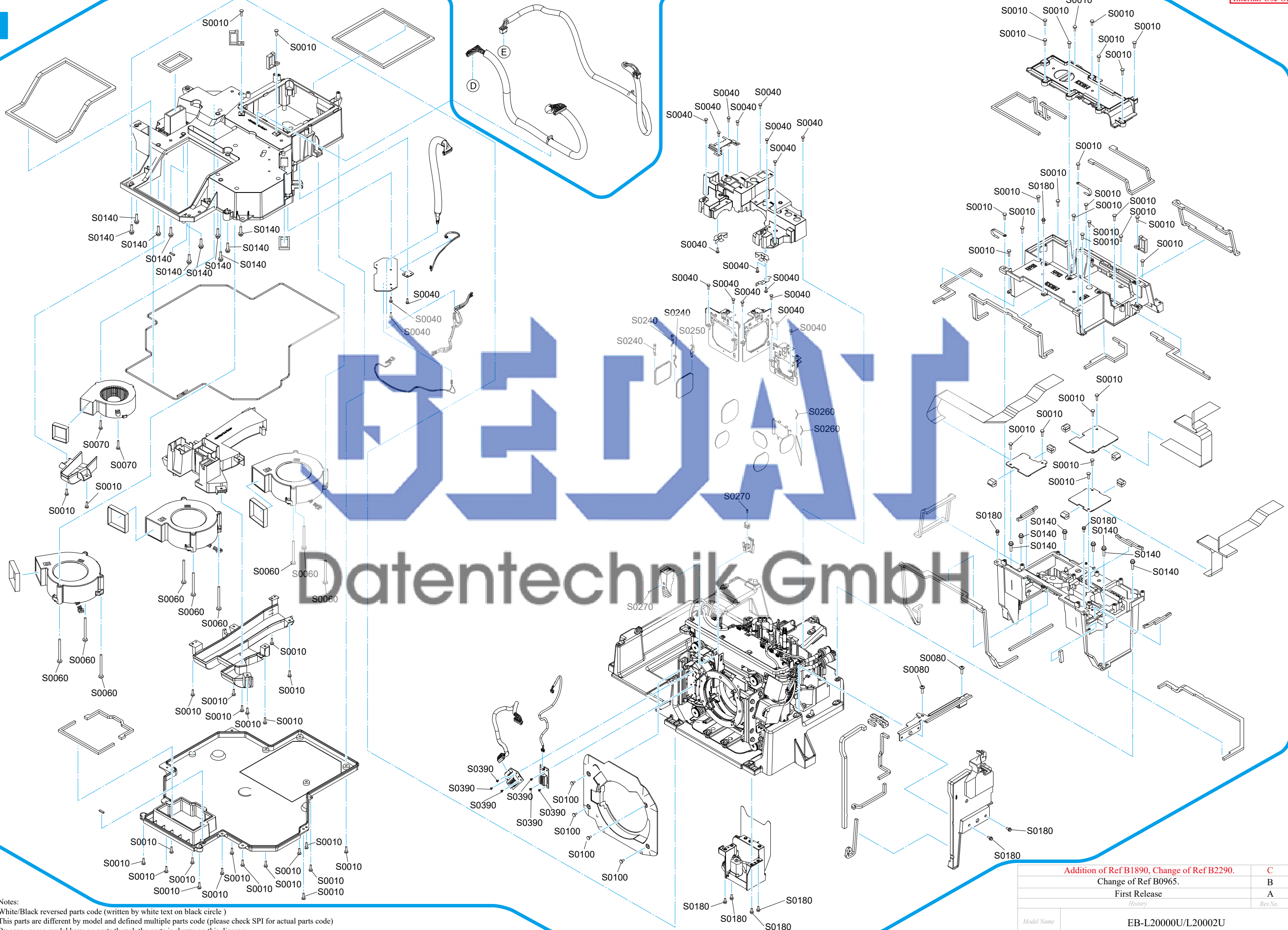

DAT

Datentechnik GmbH

Notes:
 White/Black reversed parts code (written by white text on black circle)
 This parts are different by model and defined multiple parts code (please check SPI for actual parts code)
 By case , some model have no parts though the parts is shown on this diagram.

Addition of Ref B1890, Change of Ref B2290.		C
Change of Ref B0965.		B
First Release		A
<i>History</i>		<i>Rev.No.</i>
<i>Model Name</i>	EB-L20000U/L20002U	

J

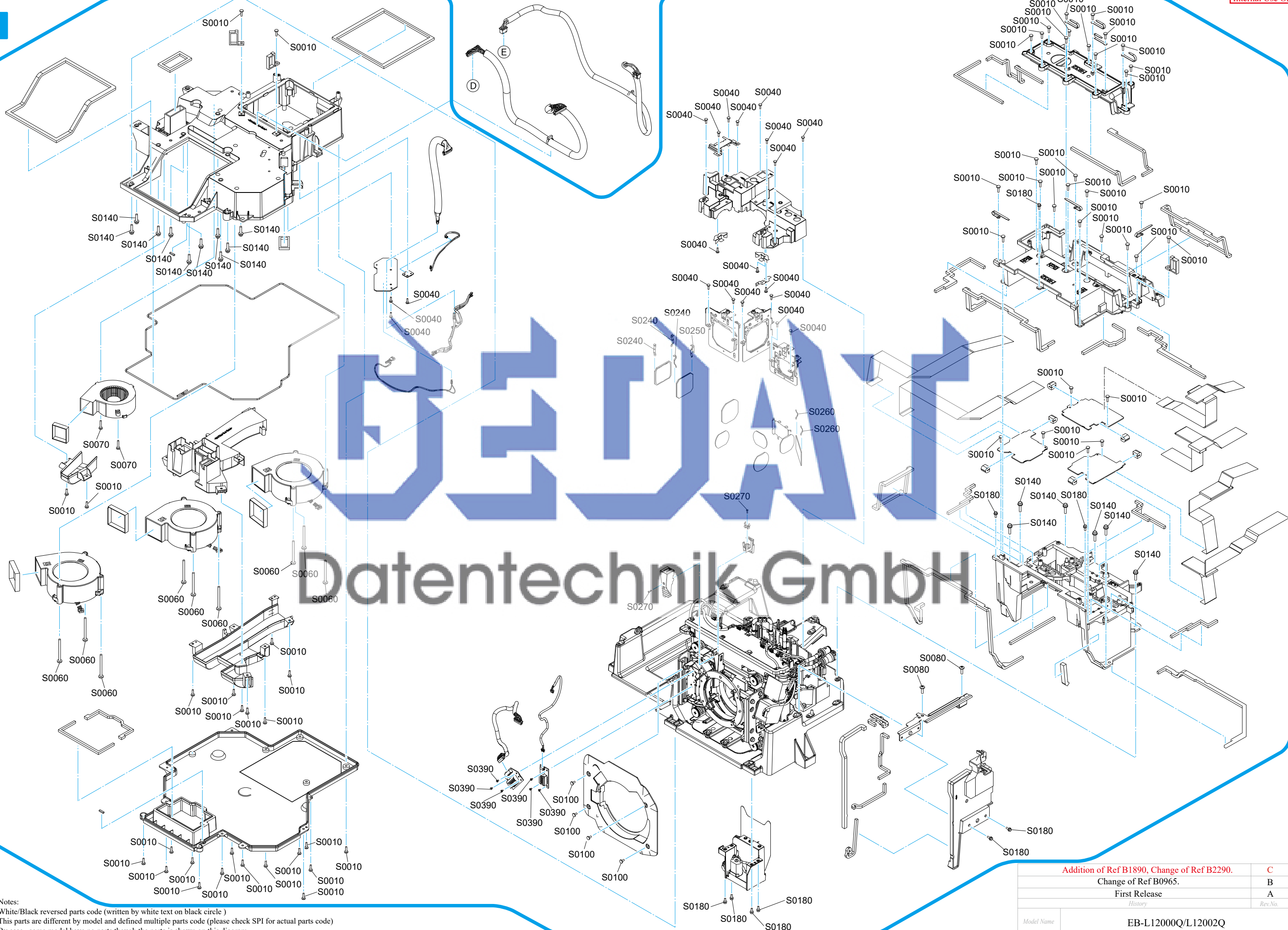

DATA

Datentechnik GmbH

Notes:
 White/Black reversed parts code (written by white text on black circle)
 This parts are different by model and defined multiple parts code (please check SPI for actual parts code)
 By case , some model have no parts though the parts is shown on this diagram.

Addition of Ref B1890, Change of Ref B2290.		C
Change of Ref B0965.		B
First Release		A
<i>History</i>		<i>Rev.No.</i>
Model Name	EB-L12000Q/L12002Q	

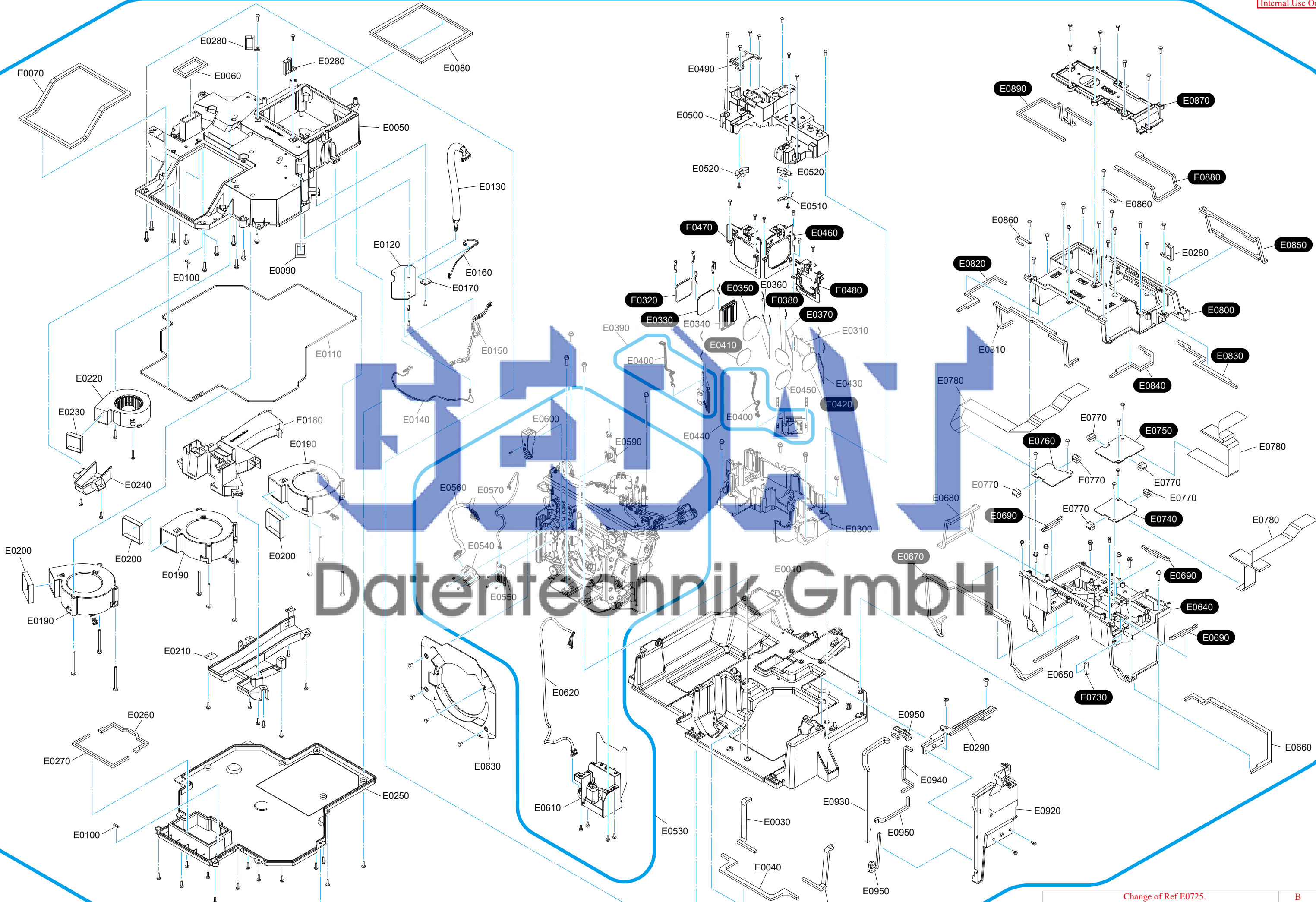

Datentechnik GmbH

Notes:
 White/Black reversed parts code (written by white text on black circle)
 This parts are different by model and defined multiple parts code (please check SPI for actual parts code)
 By case , some model have no parts though the parts is shown on this diagram.

Change of Ref E0725.		B
First Release		A
<i>History</i>		<i>Rev.No.</i>
<i>Model Name</i>	EB-L20000U/L20002U	

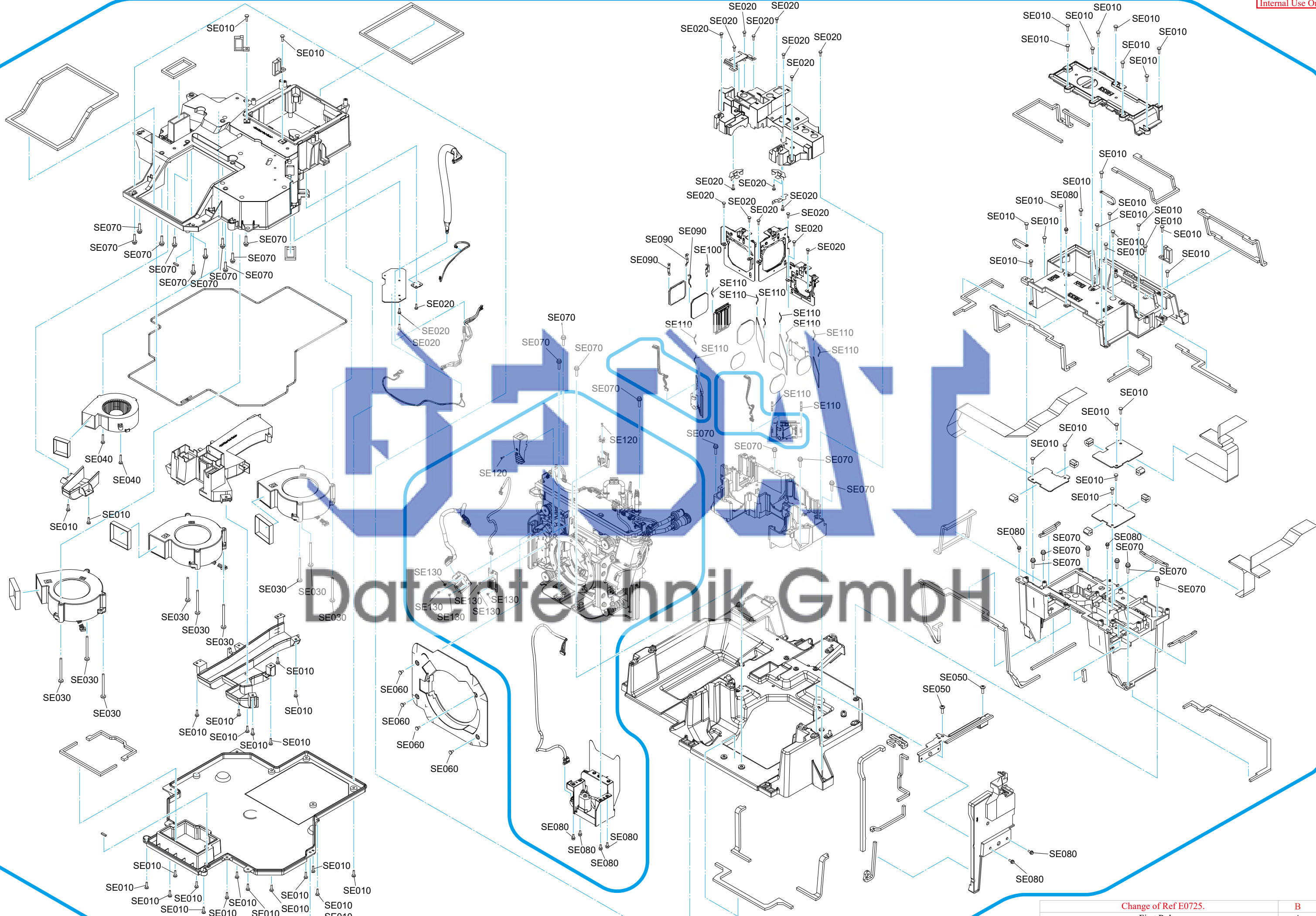

DATENTECHNIK

Datentechnik GmbH

Notes:
 White/Black reversed parts code (written by white text on black circle)
 This parts are different by model and defined multiple parts code (please check SPI for actual parts code)
 By case , some model have no parts though the parts is shown on this diagram.

Change of Ref E0725.		B
First Release		A
<i>History</i>		<i>Rev.No.</i>
<i>Model Name</i>	EB-L20000U/L20002U	

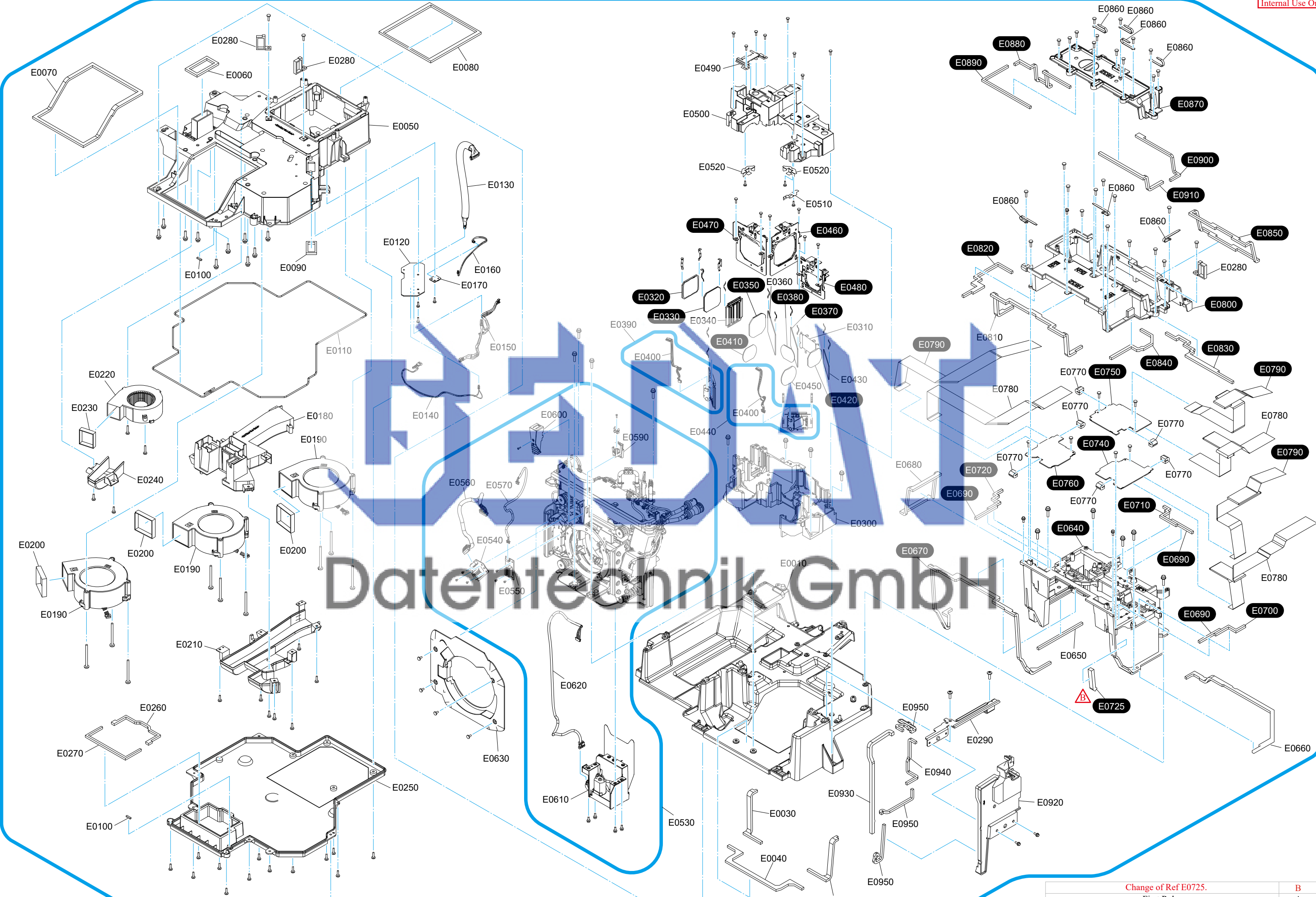

DATENTECHNIK

Datentechnik GmbH

Notes:
 White/Black reversed parts code (written by white text on black circle)
 This parts are different by model and defined multiple parts code (please check SPI for actual parts code)
 By case , some model have no parts though the parts is shown on this diagram.

Change of Ref E0725.		B
First Release		A
<i>History</i>		<i>Rev.No.</i>
<i>Model Name</i>	EB-L12000Q/L12002Q	

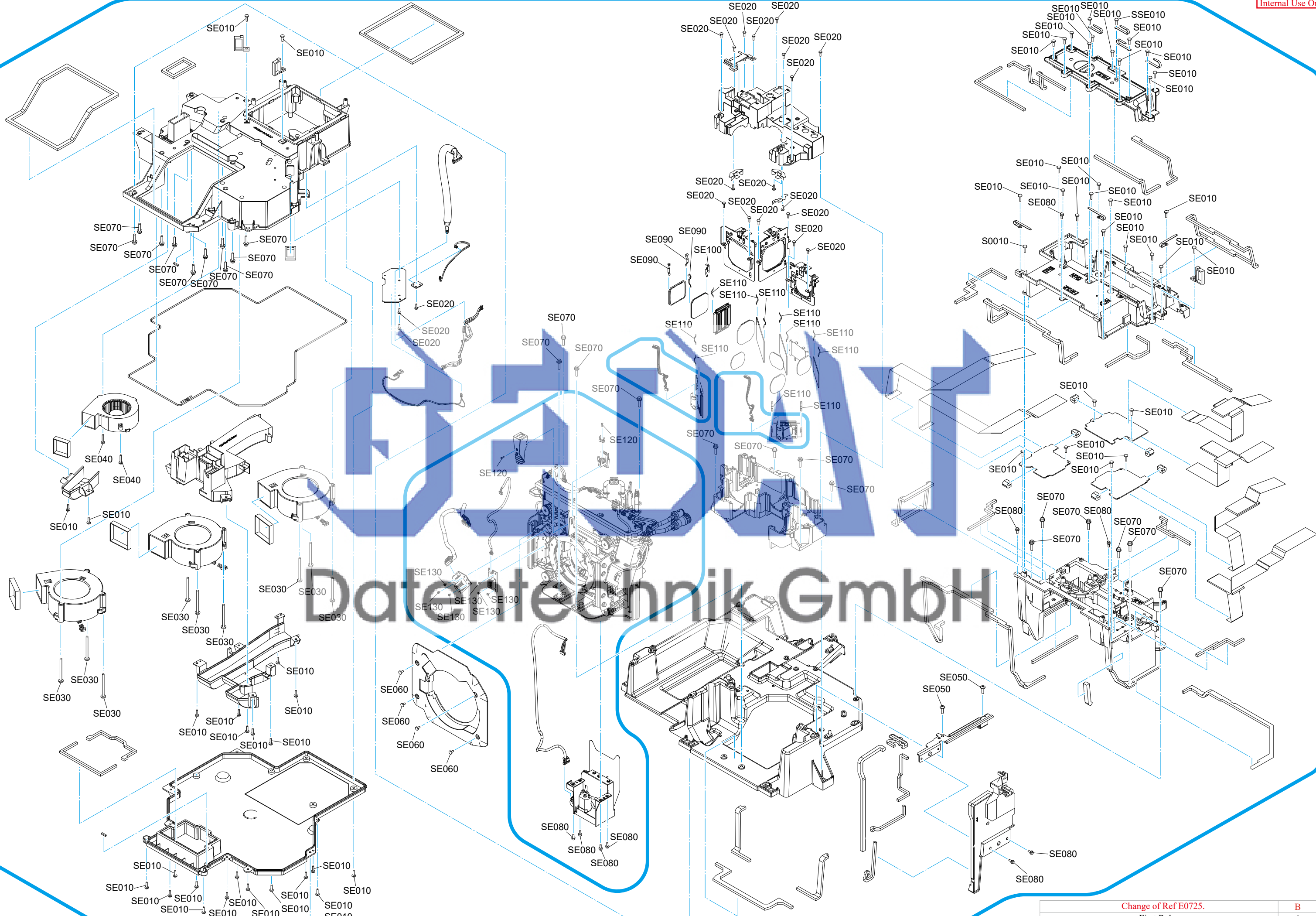

DATENTECHNIK

Datentechnik GmbH

Notes:
 White/Black reversed parts code (written by white text on black circle)
 This parts are different by model and defined multiple parts code (please check SPI for actual parts code)
 By case , some model have no parts though the parts is shown on this diagram.

Change of Ref E0725.		B
First Release		A
<i>History</i>		<i>Rev.No.</i>
<i>Model Name</i>	EB-L12000Q/L12002Q	